

This map is reproduced from / based upon the Ordnance Survey map and the aerial photography on which it is based. The Ordnance Survey map is the property of the Ordnance Survey and is reproduced here by permission of the Ordnance Survey. All rights are reserved. The Ordnance Survey name and logo are the registered trademarks of the Ordnance Survey. All other names and logos are the property of their respective owners. The Ordnance Survey name and logo are the registered trademarks of the Ordnance Survey. All other names and logos are the property of their respective owners. The Ordnance Survey name and logo are the registered trademarks of the Ordnance Survey. All other names and logos are the property of their respective owners.

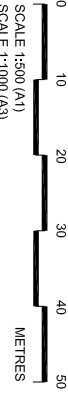
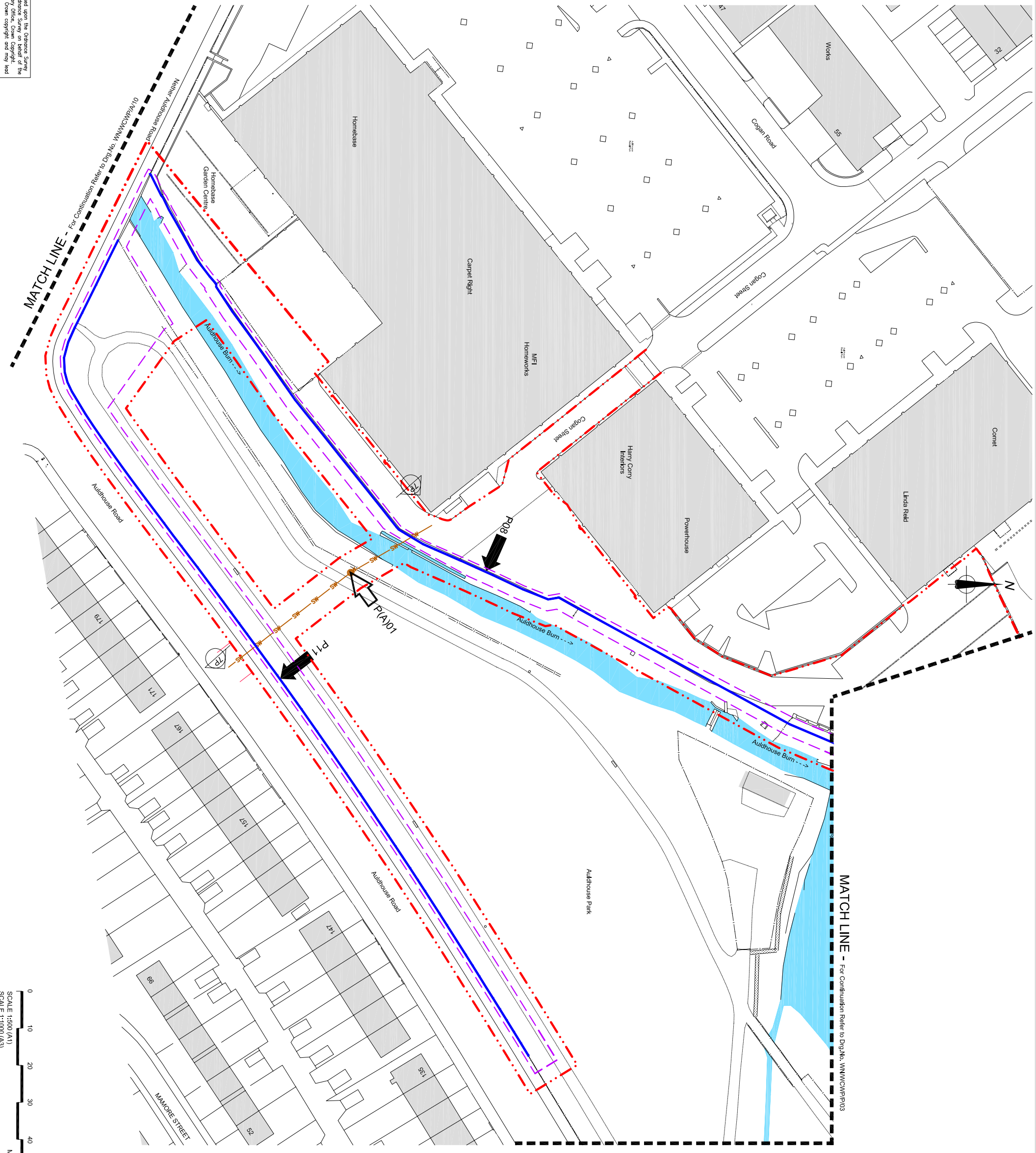

Notes:

- 1) Operations are fully described in sections 4 and 6 of the Flood Prevention Scheme.
- 2) Refer to Dwg.No. WN/WCWP/P/06 to 09 for sections.

Key

- Limit Of Lateral Deviation
- Limit of land affected by the operations and of land upon which entry is required for the purpose of carrying out the operations
- Limit of land upon which entry is required for the purpose of carrying out the operations
- Flood Defence Wall
- Flood Defence Embankment
- Underground Pumping Station and Kiosk
- Flood Prevention Operation
- Ancillary Flood Prevention Operation
- Scottish Water Sewer

THIS IS THE PLAN MARKED (WN/WCWP/P/04) REFERRED TO IN THE WHITE CART WATER FLOOD PREVENTION SCHEME 2004
 SIGNED FOR AND ON BEHALF OF GLASGOW CITY COUNCIL BY
 GEORGE BLACK, PROPER OFFICER AUTHORISED TO SIGN DOCUMENTS
 SIGNED : *George Black*
 DATE : 26 August 2004
 HEAD OF AIR, CLIMATE AND ENGINEERING DIVISION,
 SCOTTISH EXECUTIVE, ENVIRONMENT AND RURAL AFFAIRS,
 DEPARTMENT AT EDINBURGH ON
 DATE : 4 May 2006
 SIGNATURE : *Philip White*

Rev	By	Chkd	Apprvl	Date	Description
A	GDM	AMC	DLC	19/10/04	Minor Amendment



Glasgow City Council
 Glasgow City Regeneration Services
 229 Queen's Street
 G1 1QU



Project
 WHITE CART WATER
 FLOOD PREVENTION SCHEME 2004

Drawing
 URBAN CORRIDOR
 POLLOKSHAWS
 Sheet 3 of 4

Drawn by: <i>Andrew J. McArdle</i>	Date: 23-8-04
Checked by: <i>Alan McCowan</i>	Date: 23-8-04
Approved by: <i>Douglas Luke</i>	Date: 23-8-04
Drawing No. WN/WCWP/P/04	Revision A
Drawing Scale: 1:500 @ A1	